

## FOR ALL TOOLING MACHINES:

### High precision gear racks

- Length 1 m
- Quality 4

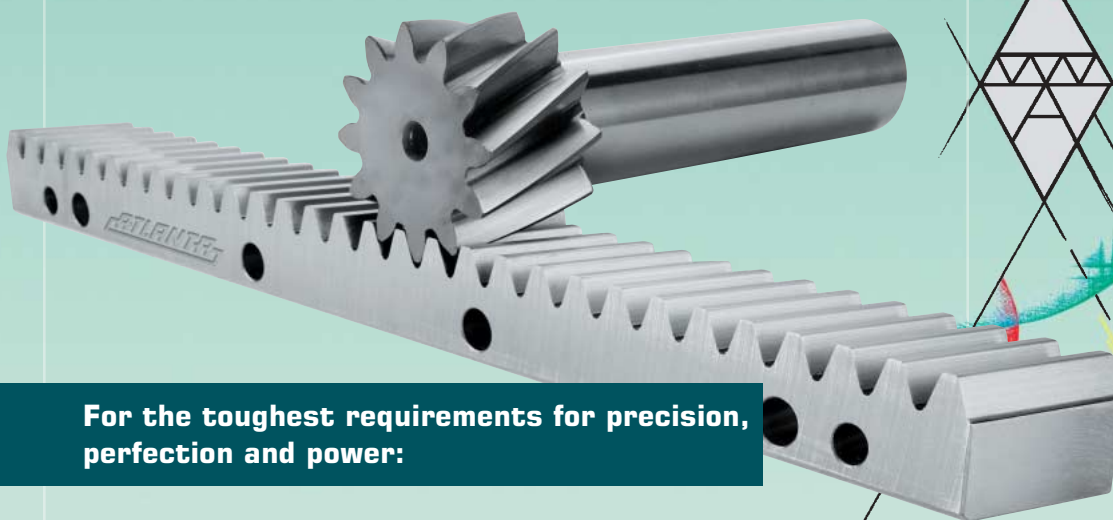

For the toughest requirements for precision, perfection and power:

#### Specifications:

- Total pitch error  $GT_f \leq 12 \mu\text{m}/1000 \text{ mm}$
- Parallelism of gearing  $\leq 15 \mu\text{m}$
- $19^\circ 31' 42''$  helical toothed and straight toothed
- Modules 5 – 6 – 8 – 10
- Torques up to 40.000 Nm
- Feed forces up to 200.000 N
- Gear racks, pinion shafts and spur gears

#### Your advantages:

- **Powerful:** the large capacity of the racks transmits even the highest forces.
- **Precise:** high precision pitch – the need for electronic compensation is minimized or even eliminated. The high precision parallelism of the gearing allows drives with extremely low backlash without preloading.
- **Innovative:** new patent protected measuring and assembly aids allow flawless assembly.
- **Flexible:** comprehensive and accurate measurement reports are available on request. We can also supply the racks with additional mounting holes or slotted holes for more flexibility.
- **Complete:** gear racks, pinions, spur gears, and servo drives – everything from a single source.
- **Reliable:** the tried and tested ATLANTA lubrication systems guarantee a long life.

## Module 5

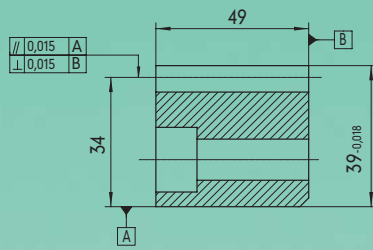

Quality 4	Pitch error $GT_f \leq 0,012 \text{ mm}/1000 \text{ mm}$	Torque		Feed Force
Item number		$Z_R = 20$ teeth	$Z_R = 40$ teeth	
48 50 105	Helical toothed	1800 Nm	3600 Nm	34500 N
46 50 105	Straight toothed	1600 Nm	3200 Nm	32000 N

## Module 6

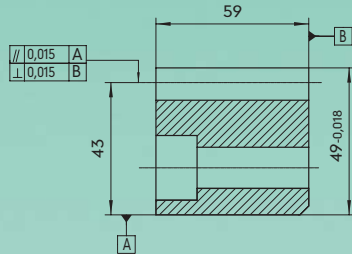

Quality 4	Pitch error $GT_f \leq 0,012 \text{ mm}/1000 \text{ mm}$	Torque		Feed Force
Item number		$Z_R = 20$ teeth	$Z_R = 40$ teeth	
48 60 105	Helical toothed	3200 Nm	6400 Nm	50000 N
46 60 105	Straight toothed	2800 Nm	5700 Nm	47600 N

## Module 8

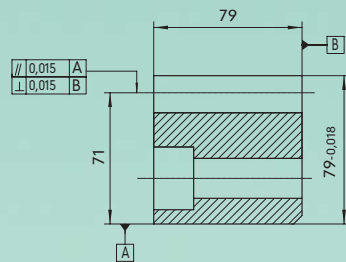

Quality 4	Pitch error $GT_f \leq 0,012 \text{ mm}/1000 \text{ mm}$	Torque		Feed Force
Item number		$Z_R = 20$ teeth	$Z_R = 40$ teeth	
48 80 105	Helical toothed	7800 Nm	15600 Nm	91600 N
46 80 105	Straight toothed	6800 Nm	10200 Nm	85000 N

## Module 10

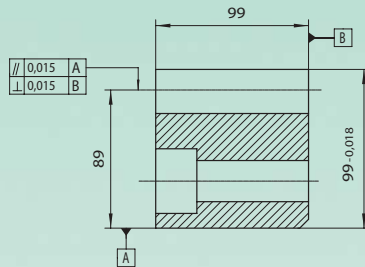

Quality 4	Pitch error $GT_f \leq 0,012 \text{ mm}/1000 \text{ mm}$	Torque		Feed Force
Item number		$Z_R = 20$ teeth	$Z_R = 40$ teeth	
48 10 105	Helical toothed	15000 Nm	30000 Nm	141000 N
46 10 105	Straight toothed	13000 Nm	26000 Nm	130000 N

Other gear rack lengths and other modules available on request.

For spur gears, pinion shafts and determining gear centers see ATLANTA catalogue Servo Drive System.



**ATLANTA**

**ATLANTA Antriebssysteme**

E. Seidenspinner GmbH & Co. KG

Postfach 1161 · P.O. Box 1161  
D-74301 Bietigheim-Bissingen

Fon: +49(0)71 42/70 01-0

Fax: +49(0)71 42/70 01-99

E-Mail: info@atlantagmbh.de  
www.atlantagmbh.de